



## 规格书 Specification

品类/Term: Data connector  
数据连接器

型号/Model: SWDR6-MS-R

承认签章/Admit signature						
供应商确认/supplier			客户公司承认/customer			
工程师 engineer	审核 audit	批准 approval	工程师engineer	审核audit	批准approval	
LXM	WXW	CJY				
盖章签署 signature			盖章签署 signature			
日期/date			日期/date			

## 一、AKD-DATA-CAT6Y 产品外观 (Product Appearance)



## 二、产品特性 (Product Features)

- 1、圆形外观RJ45 CAT6网络插座 锌合金压铸 金属外壳 (Round appearance Rj45 CAT6 network socket Zinc alloy die-casting metal shell)
- 2、外壳颜色：镀铬银色款、电泳漆黑色款 (Shell color: chrome-plated silver, electrophoretic paint black)
- 3、国际标准8P8C网络，超六类网络千兆网速，高弹性铍铜镀金内芯，兼容六类、超五类网络水晶头 (International standard 8P8C network, CAT6 network Gigabit network speed, highly elastic beryllium copper gold-plated inner core, compatible with CAT6 and CAT5e network crystal plugs)
- 4、尼龙塑料内芯，CAT6前端母口与后端母口 (Nylon plastic inner core, CAT6 front female port and rear female port)
- 5、外壳与内芯采用铆压式结构，可以牢固的将内芯固定在圆形外壳中，生产安装更简洁方便，大大提升生产效率 (The shell and inner core adopt a riveted structure, which can firmly fix the inner core in the round shell, making the production and installation more simple and convenient, and greatly improving production efficiency)
- 6、结合外壳圆形尾螺纹结构，后螺母安装方式无需铆钉 (Combined with the rounded tail thread structure of the housing, the rear nut can be installed without rivets)

### 三、技术参数 (Technical Parameters)

#### 1、机械参数 (Mechanical parameters)

使用寿命 (service life)	$\geq 500$ mating cycles
插拔力 (Insertion force)	$\leq 50$ N

#### 2、电气参数 (Electrical parameters)

接触电阻 (Contact resistance)	$< 40$ m $\Omega$
额定电流 (Rated current)	1.2A
额定电压 (Rated voltage)	42 V
绝缘电阻 (Insulation resistance)	$\geq 500$ m $\Omega$
带宽频率 (Frequency range)	10HZ~500HZ
传输等级 (Transmission performance)	CAT 6

#### 3、材料和使用环境 (Materials and use environment)

外壳 (shell)	Zinc diecast
外壳电镀 (Shell Plating)	Pearl Cr / Electrophoretic
内芯 (Inner core)	Pa66
触点 (contacts)	Bronze
触点表面 (contact surface)	Au
使用温度范围 (Operating temperature range)	-30°C to +80°C

#### 四、产品外形尺寸 (Product Dimensions)

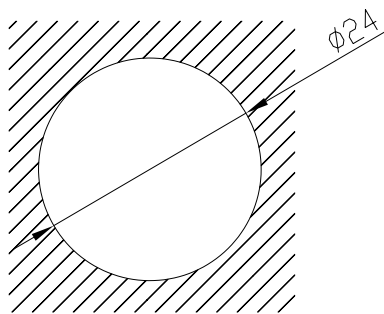
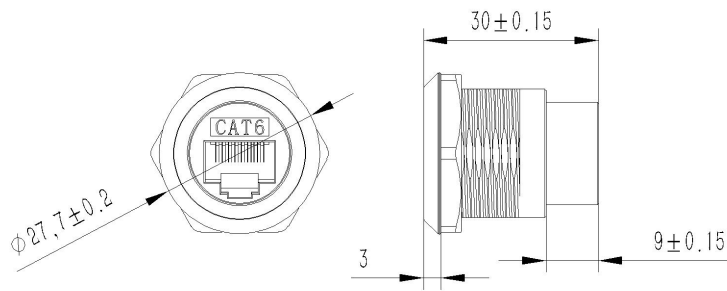

安装开孔尺寸